

**Windload Test Data**

**Fastener Configuration - Pattern A (24 screws)**

On Center: 16"  
Sheathing: 7/16 OSB  
Fasteners: SFS Intec TW-S-12

\*Allowable Design Pressure (psf)  
With Aluminum Edge Reveals: 38  
Without Aluminum Edge Reveals: 30

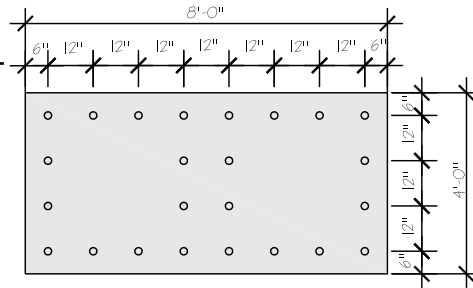

**Fastener Configuration - Pattern B (18 screws)**

On Center: 16"  
Sheathing: 7/16 OSB  
Fasteners: SFS Intec TW-S-12

\*Allowable Design Pressure (psf)  
With Aluminum Edge Reveals: 30  
Without Aluminum Edge Reveals: 22

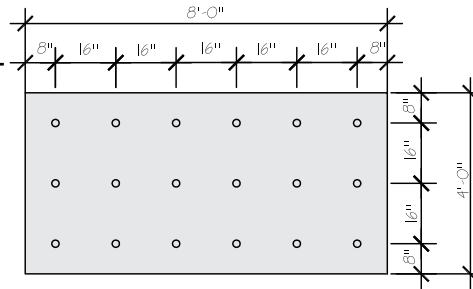

**Fastener Configuration - Pattern C (16 screws)**

On Center: 16"  
Sheathing: 7/16 OSB  
Fasteners: SFS Intec TW-S-12

\*Allowable Design Pressure (psf)  
With Aluminum Edge Reveals: 25  
Without Aluminum Edge Reveals: 17

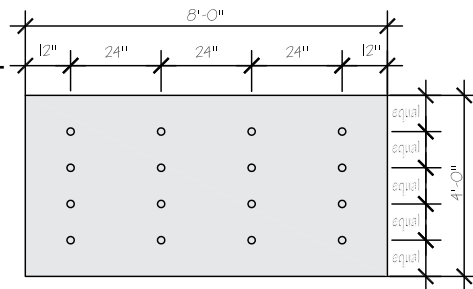

*Important note: Geographic location and specific design parameters must be accounted for when determining the optimum fastening pattern for a particular project.*

*\*When tested in accordance with ASTM E330. Allowable Design Pressure includes a 3.0 Factor of Safety.*