

PLYCEM USA, LLC
 396 W. Greens Road,
 Suite 300 Houston, TX
 77067 USA

RE: RECOGNITION OF HEAVY SHAKE STRIGHT EDGE AND HEAVY SHAKE STAGGERED EDGE AS APPROVED PLYCEM FIBER CEMENT PRODUCTS

To Whom it May Concern:

QAI Laboratories, Ltd. (QAI) is an International Accreditation Service, Inc. (IAS) accredited independent third-party testing (TL-672, TL239, TL282), third-party inspection (AA723), and third-party certification agency (PCA-118) for evaluation of claddings including use in Types I-IV non-combustible construction.

Plycem will be producing the Straight Edge Shake and the Staggered Edge Shake, traditionally produced in 1/4-inch (6.4mm) thickness, in a 5/16-inch (7.9mm) thickness based on the Straight Edge Shake and Staggered Edge Shake models that are currently approved under the QAI Code Evaluation Report CER_{US}-1012. These products will be named Heavy Shake Straight Edge and Heavy Shake Staggered Edge. All dimensions of the Heavy Shake products will be consistent with the Straight Edge Shake and Staggered Edge Shake, except for the thickness. Figures 1 and 2 outline the dimensions of the product.

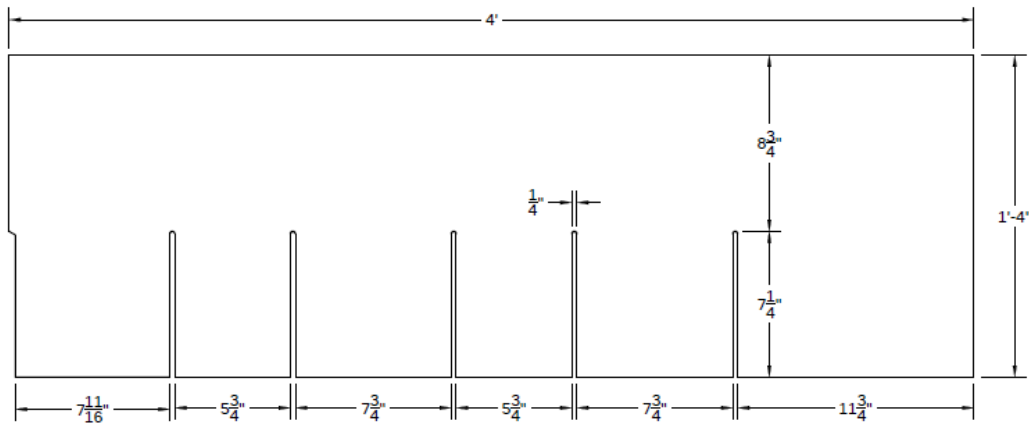

Figure 1 – Shake Straight Edge

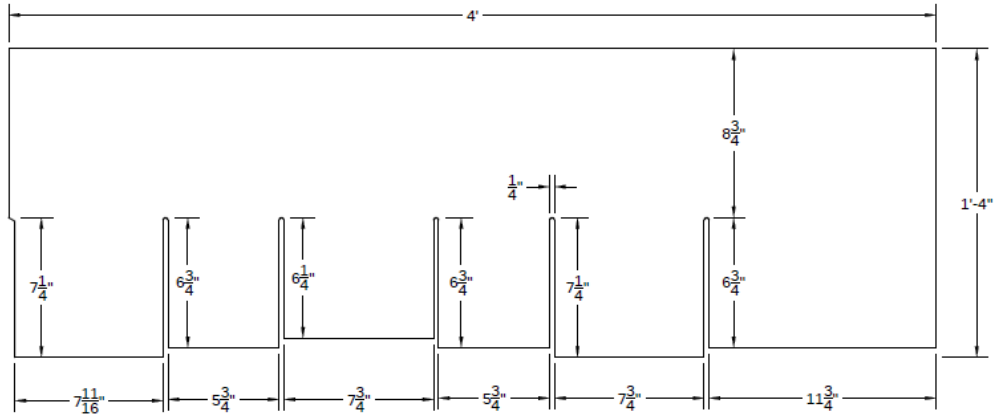

Figure 2 – Shake Staggered Edge

The Heavy Shake Straight Edge and Heavy Shake Staggered Edge will be manufactured from the same $\frac{5}{16}$ -inch (7.9mm) fiber cement product that is currently used on the Lap Siding, Panel Siding and Shake Select products approved under the CER_{US}-1012.

The Heavy Shake Straight Edge and Heavy Shake Staggered Edge will be very similar in dimensions and identical in installation practice to the Shake Select Random Square Straight Edge-7" and the Shake Select Random Square Staggered Edge. See Figure 3 and Figure 4 for dimensional drawings of these products.

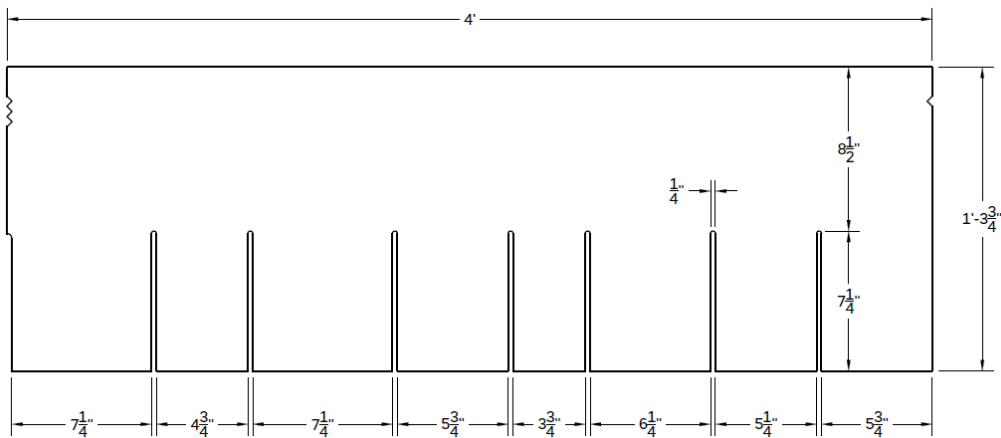

Figure 3 – Shake Select Straight 7"

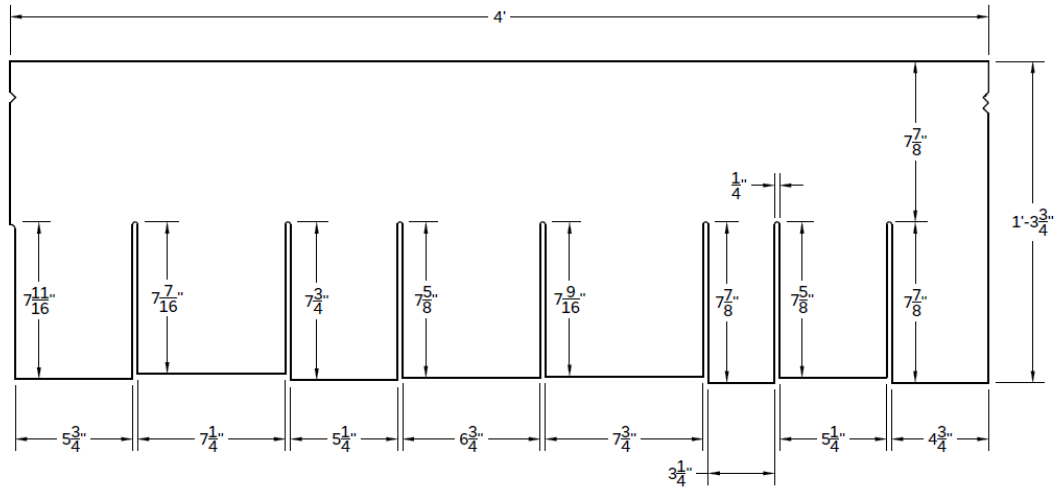

Figure 4 – Shake Select Staggered

The CER_{US}-1012, Table 5 outlines the Allowable Design Loads for all the Shake Select Siding products and does not differentiate between the various models outlined in Table 1 of CER_{US}-1012. The variations between the Heavy Shake Straight Edge compared to the Shake Select Random Square Straight Edge and the Heavy Shake Staggered Edge compared to the Shake Select Random Square Staggered Edge are less than the variations in models between the Shake Select Random Square Straight Edge/Staggered Edge and that of the Half Rounds or Octagon shapes and all are approved for the allowable design loads as outlined in Table 5.

With the Heavy Shake products manufactured at a thickness of $\frac{5}{16}$ -inch (7.9mm) and following the same installation methods as outlined in Section 4.2.3 of the CER_{US}-1012 the Allowable Design Loads as outlined in Table 5 of the CER_{US}-1012 could be applied to the Heavy Shake Straight Edge and Heavy Shake Staggered Edge.

In conclusion the Heavy Shake Straight Edge and Heavy Shake Staggered Edge will be $\frac{5}{16}$ -inch (7.9mm) thick fiber cement board products manufactured using the same formulation currently approved for use with the Lap, Siding and Shake products outlined under the QAI CER_{US}-1012 report and the allowable design loads of Table 5 could be used to support the design requirements when using the Heavy Shake Straight Edge and Heave Shake Staggered Edge products.

For the most up-to-date information regarding products certified by QAI, please visit: www.qai.org

If there are any questions, please contact the undersigned below.

**Written on Behalf of
QAI Laboratories**

**Jason Friedrich P.E.
Engineering Manager**